



**Harleys Field, Abbeymead, Gloucester, GL4 4RN**

**Guide Price £290,000**



**MICHAEL TUCK**

**The Agent with 5 star customer service**

**1 Harleys Field, Abbeymead,  
Gloucester, Gloucestershire, GL4 4RN**

**Guide Price £290,000**

. Council Tax Band C



**3 Bedrooms**



**2 Bathrooms**



**2 Receptions**

### Features

- \* 3 Bedroom Semi
- \* Garage & Off road parking
- \* Cloak room
- \* Gas Central Heating
- \* Upvc double glazing
- \* Conservatory
- \* Private garden
- \* EPC C COUNCIL TAX BAND C
- \* No chain
- \* Viewing recommended

### Michael Tuck Estate and Letting Agents

2 Mead Road Abbeymead Gloucester Gloucestershire GL4 5GL

01452 612020

estates.abbeymead@michaeltuck.co.uk

### The Property

\*\*\*\*BE QUICK TO VIEW THIS 3 BEDROOM SEMI WITH GARAGE OFFERED FOR SALE WITH NO CHAIN\*\*\*\*

Michael Tuck estate Agents are pleased to offer for sale with no chain this 3 bedroom semi located in a sought after cul de sac known as "Harleys Field" in the popular suburb of Abbeymead. The property offers good size accommodation with cloak room, Lounge, Kitchen/Diner and large Conservatory and on the first floor 3 bedrooms and Shower room. Outside you will find a driveway and attached single garage and private rear garden. Viewing is strongly advised call 01452 612020 to book your visit today

**Lounge** 15' 2" x 14' 10" (4.63m x 4.51m)

**Kitchen/Diner** 14' 8" x 10' 1" (4.48m x 3.07m)

**Conservatory** 11' 3" x 9' 3" (3.42m x 2.82m)

**Bedroom 1** 12' 5" x 8' 2" (3.78m x 2.50m)

**Bedroom 2** 11' 0" x 8' 6" (3.35m x 2.58m)

**Bedroom 3** 9' 0" x 6' 6" (2.75m x 1.98m)

### Agents note

we are obliged to inform you that the seller of the property is related to a employee of Michael Tuck estate agents.











GROUND FLOOR

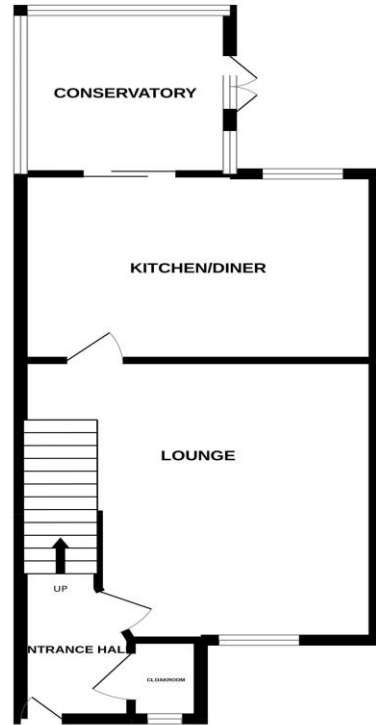

1ST FLOOR

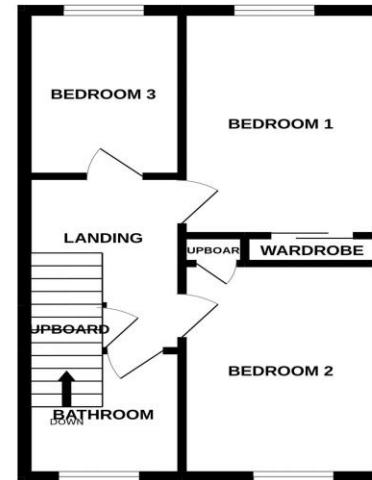

Whilst every attempt has been made to ensure the accuracy of the floorplan contained here, measurements of doors, windows, rooms and any other items are approximate and no responsibility is taken for any error, omission or mis-statement. This plan is for illustrative purposes only and should be used as such by any prospective purchaser. The services, systems and appliances shown have not been tested and no guarantee as to their operability or efficiency can be given.  
Made with Metropix ©2022

### FOR ILLUSTRATIVE PURPOSES ONLY – NOT TO SCALE

The position and size of doors, windows, appliances, and other features are approximate only.  
Unauthorised reproduction prohibited

**Important notice:** Michael Tuck, its clients and any joints give notice that 1: They are not authorised to make or give any representations or warranties in relation to the property either here or elsewhere, either on their own behalf of their client or otherwise. They assume no responsibility for any statement that may be made in these particulars. These particulars do not form part of any offer or contract and must not be relied upon as statements or representation of fact. 2: Any areas, measurements or distances are approximate. The text, photographs and plans are for guidance only and are not necessarily comprehensive. It should not be assumed that the property has all necessary planning, building regulation or other consents and Michael Tuck have not tested any services, equipment or facilities. Purchasers must satisfy themselves by inspection or otherwise.

